

## Roof box 390 / 330

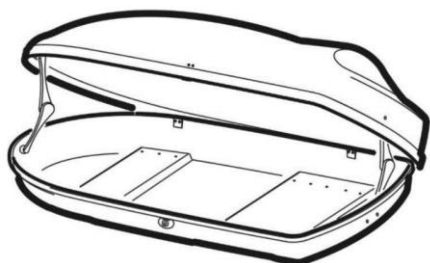

66730ADE01 / 66730ADE11

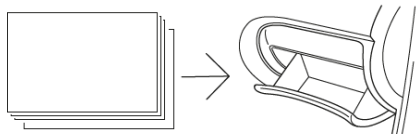

P II



0.20 hours

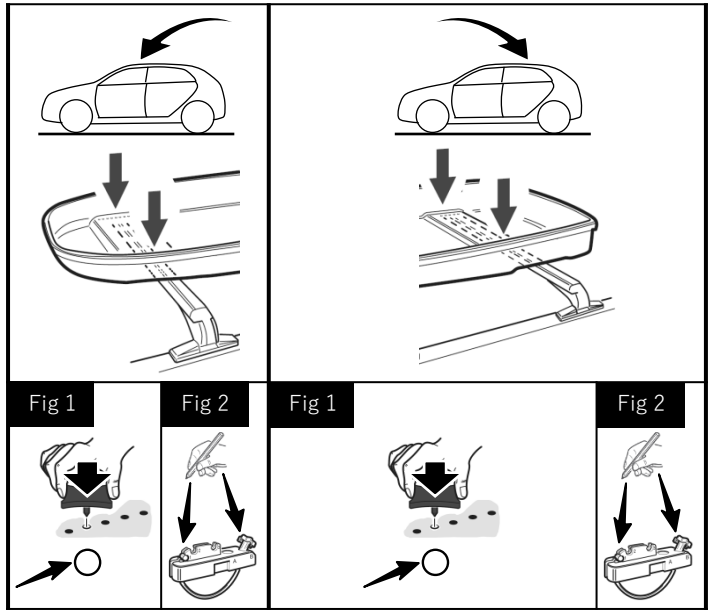
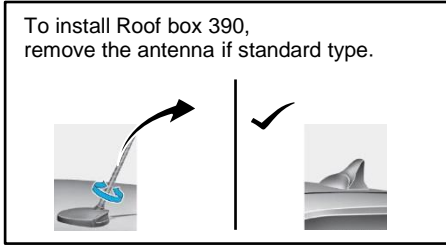
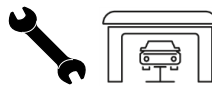

Model	Carrier	Roof box	Holes					Position	Holes 330 & 390																Position
			1	2	3	4	5		6	7	8	9	10	11	12	13	14	390							
Ceed 5dr (CD)	J7210ADE00AL J7210ADE01AL	330 & 390	○	●	○	●	●	2 - A	●	●	●	●	○	●	○	●	●	●	●	●	2 - B				
	J7210ADE00ST		○	●	○	●	●	3 - A	●	●	●	●	○	●	○	●	●	●	●	●	3 - A				
Ceed SW (CD)	J7211ADE00AL J7211ADE01AL	330 & 390	●	○	●	○	●	2 - A	●	●	●	●	○	●	○	●	●	●	●	●	2 - A				
	J7211ADE00ST		●	○	●	○	●	3 - A	●	●	●	●	○	●	○	●	●	●	●	●	3 - A				
Cee'd 5dr (JD)	A2210ADE00AL	330 & 390	●	●	○	●	○	2 - A	●	●	●	●	○	●	○	●	●	●	●	●	2 - A				
Cee'd SW (JD)	Roof box 330 / 390 not applicable (tailgate interference)																								
e-Soul (SK3)	J2211ADE10AL	330 & 390	●	○	●	○	●	2 - A	●	●	○	●	●	○	●	●	●	●	●	●	2 - B				
EV6 (CV1)	No genuine Carrier																								
EV9 (MV1)	DO211ADE00AL-GL	330 & 390	○	●	●	○	●	2 - B	●	●	●	●	○	●	●	○	●	●	●	●	2 - B				
Niro (DE)	G5211ADE00AL	330 & 390	●	●	○	●	○	2 - A	●	●	●	○	●	○	●	●	●	●	●	●	2 - A				
Niro (SG2)	AT210ADE00AL	330 & 390	○	●	○	●	●	2 - A	●	●	●	●	○	●	●	○	●	○	●	●	2 - B				
Optima SW (JF)	D4211ADE00AL	330	○	●	○	●	●	2 - A	●	●	●	●	●	○	○	○	○	N/A	○	2 - A					
		390	●	●	○	●	○	2 - A	●	●	●	●	●	●	●	○	○	○	○	○	2 - A				
ProCeed (CD)	J7210ADE20AL J7210ADE21AL	330 & 390	○	●	○	●	●	2 - A	●	●	●	●	○	●	○	○	○	○	○	○	2 - B				
	B2211ADE00AL		○	●	○	●	●	2 - A	●	●	●	●	○	○	○	○	○	○	○	○	2 - A				
Soul (PS)	B2211ADE01AL	330	○	●	○	●	●	2 - A	●	●	●	●	○	○	○	○	○	○	○	○	2 - A				
	B2210ADE00AL		○	●	○	●	●	2 - A	●	●	●	●	○	○	○	○	○	○	○	○	2 - A				
	B2211ADE00AL		○	●	○	●	●	2 - A	●	●	●	●	○	○	○	○	○	○	○	○	2 - A				
	B2211ADE00AL	390	●	●	○	●	○	2 - A	●	●	●	●	●	○	○	○	○	○	○	○	2 - A				
	B2211ADE01AL		●	●	○	●	○	2 - A	●	●	●	●	○	○	○	○	○	○	○	○	2 - A				
B2210ADE00AL	390	●	●	○	●	○	2 - A	●	●	●	●	○	○	○	○	○	○	○	○	2 - A					

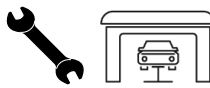

Model	Carrier	Roof box	Holes					Position	Holes 330 & 390											Position								
			1	2	3	4	5		6	7	8	9	10	11	12	13	14	390	15		16							
<b>Sorento (MQ4)</b>	P2211ADE00AL	330 & 390	○	●	○	●	●	2 - A	●	●	●	○	●	●	○	●	●	●	●	●	●	●	●	●	●	●	●	2 - B
	P2211ADE01AL		○	●	○	●	●	2 - A	●	●	●	○	●	●	○	●	●	●	●	●	●	●	●	●	●	●	●	2 - A
<b>Sorento (UM)</b>	C5211ADE00AL	330 & 390	●	●	○	●	○	2 - A	●	●	●	○	●	○	●	○	●	●	●	●	●	●	●	●	●	●	●	2 - A
	R2211ADE00ST		●	○	●	○	●	3 - A	●	●	●	○	●	○	●	○	●	●	●	●	●	●	●	●	●	●	●	2 - B
<b>Sportage (NQ5)</b>	R2211ADE00AL	330 & 390	●	○	●	○	●	2 - A	●	●	●	○	●	○	●	○	●	●	●	●	●	●	●	●	●	●	●	1 - B
	F1211ADE00AL		330 & 390	●	●	○	●	○	2 - A	●	●	●	○	●	○	●	○	●	●	●	●	●	●	●	●	●	●	●
F1211ADE10AL	●	●		○	●	○	2 - A	●	●	●	○	●	○	●	○	●	●	●	●	●	●	●	●	●	●	●	●	2 - A
F1211ADE00ST	●	●		○	●	○	3 - A	●	●	●	○	●	○	●	○	●	●	●	●	●	●	●	●	●	●	●	●	3 - A
F1211ADE10ST	●	●		○	●	○	3 - A	●	●	●	○	●	○	●	○	●	●	●	●	●	●	●	●	●	●	●	●	3 - A
<b>Stonic (YB CUV)</b>	E8300-4D050	Only 330	●	●	○	●	○	2 - A	●	●	○	●	○	●	○	●	○	●	○	●	○	●	○	●	○	●	○	2 - A
	E8300-4D000		●	●	○	●	○	3 - A	●	●	○	●	○	●	○	●	○	●	○	●	○	●	○	●	○	●	○	3 - A
<b>Venga (YN)</b>	1P210ADE00AL	330 & 390	●	●	○	●	○	2 - A	●	●	●	○	●	○	●	○	●	○	●	○	●	○	●	○	●	○	●	2 - A
	1P210ADE00ME		●	●	○	●	○	3 - A	●	●	●	○	●	○	●	○	●	○	●	○	●	○	●	○	●	○	●	3 - A
<b>XCeed (CD CUV)</b>	J7211ADE00AL	330 & 390	○	●	○	●	●	2 - A	●	●	○	●	○	●	○	●	○	●	○	●	○	●	○	●	○	●	○	1 - B
	J7211ADE00ST		○	●	○	●	●	3 - A	●	●	○	●	○	●	○	●	○	●	○	●	○	●	○	●	○	●	○	2 - B